

Tieton Shower Door

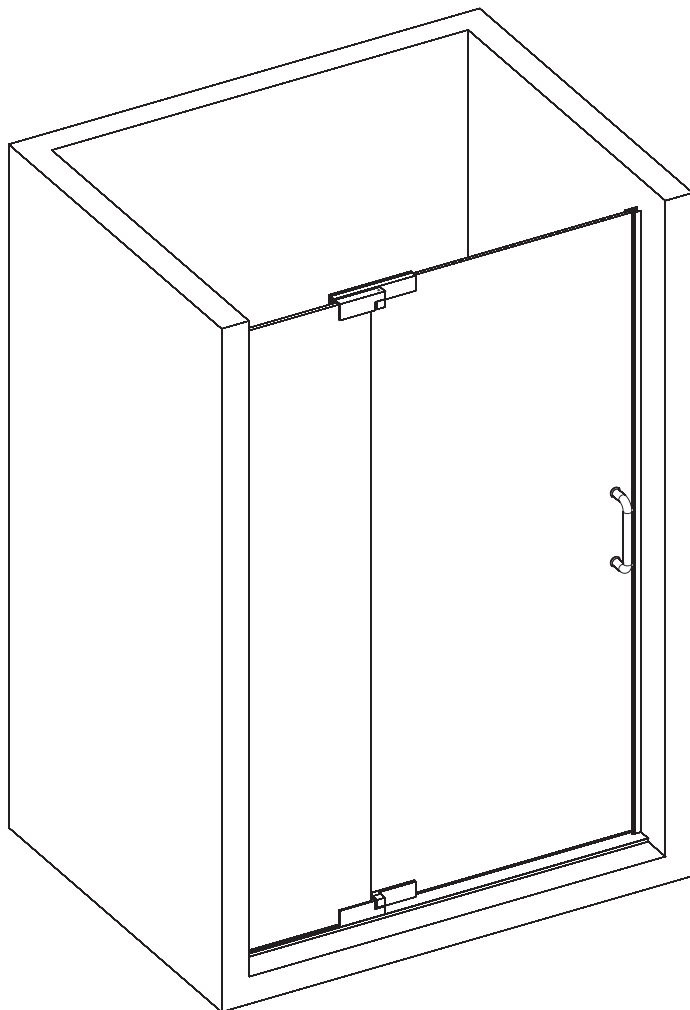

SAFETY INFORMATION

CAUTION

Risk of personal injury. Always wear safety glasses while cutting or drilling.

Risk of injury or product damage. Unframed tempered glass should not contact hard surfaces or it may shatter. Do not touch the edge of the tempered glass panel with tools or any hard objects. Do not set the unframed tempered glass edge directly on the floor.

Risk of injury or product damage. Do not attempt to cut tempered glass. Tempered glass shatters when it is cut.

Risk of product damage and property damage. This shower door is very heavy. Do not install it to plastic shower modules or drywall unless additional support is provided behind the wall.

- Your new shower door can be installed with the door opening to the right or left. Install the door with the pivot side away from the shower head for best results. These instructions show the door installed with a left side swing. Doors that swing to the right would be opposite. The shower door is left or right opening. Please refer to the box print.
- Before starting the installation, lay out and identify all of the parts. Inspect them for damage.
- Some steps in the instructions are specific to a right or left side hinge installation. Follow the instructions which pertain to your installation configuration.
- Closely follow the instructions pertaining to the sealant application on the door. Sealing areas other than those shown may cause leakage.
- Two people should perform this installation.

TOOLS

Silicone Sealant

Masking Tape

Tape Measure

Level

Pencil

Center Punch

File

Drill and Assorted Bits

Claw Hammer

Safety Glasses

1/4" and 5/32" Hex Wrenches

Assorted Screwdrivers

Knife

Miter Saw or Hack Saw with 32 Teeth/Inch Blade

Miter Box

Caulk Gun

Pliers

Tieton Shower Door

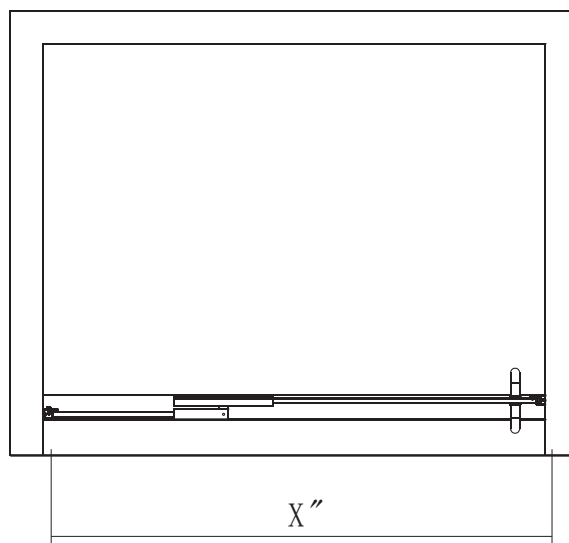
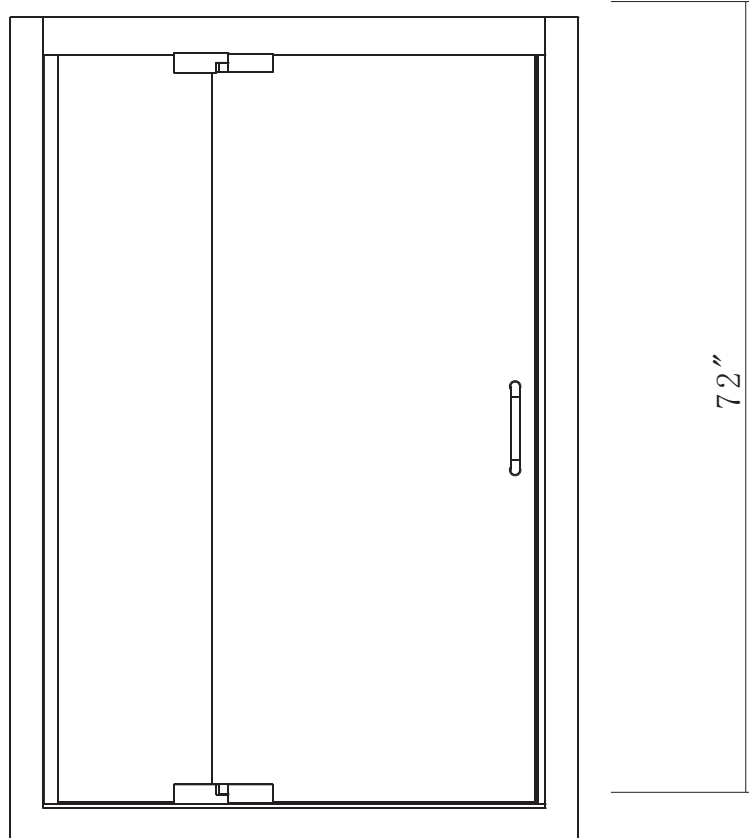

Tieton Shower Door

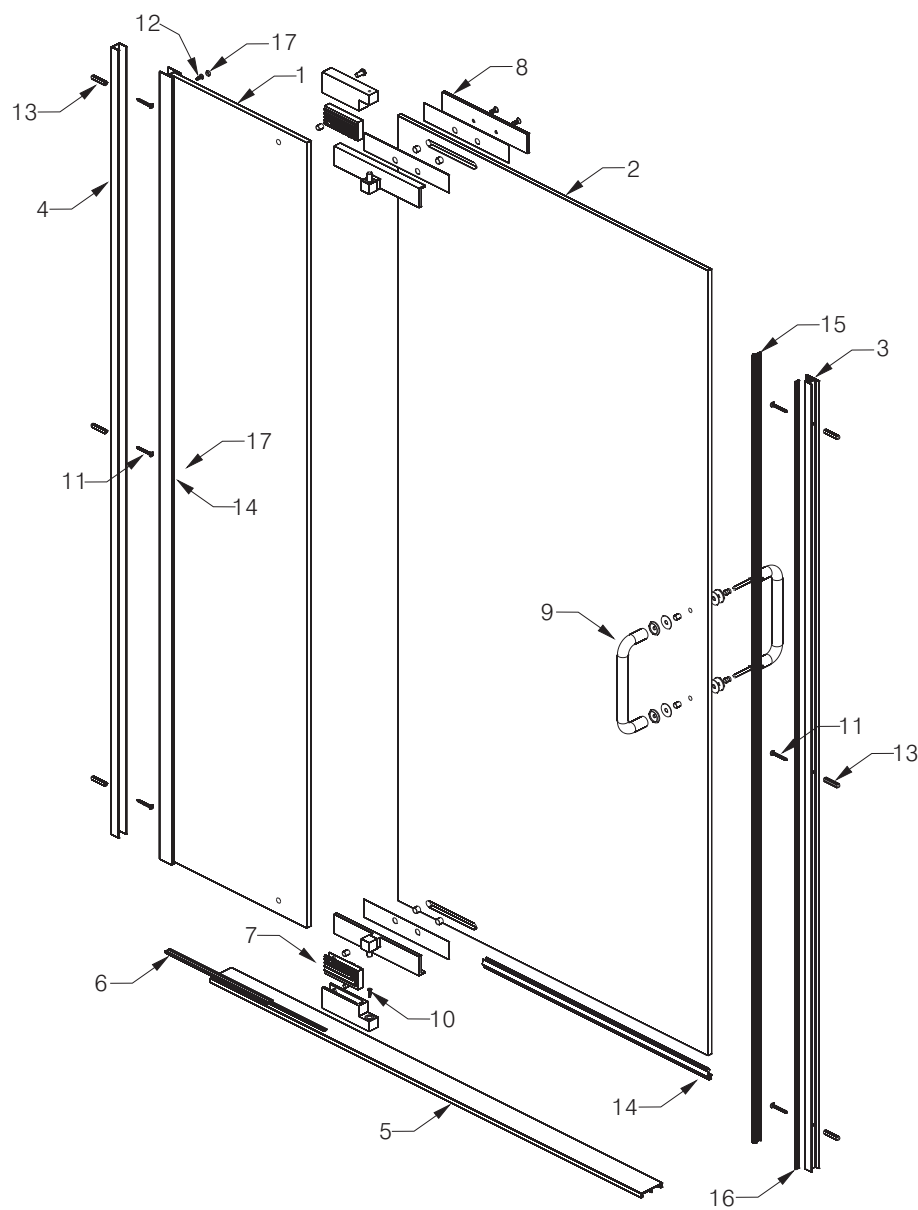

Code	Description
T1	Fixed panel
T2	Glass door
T3	Wall jamb
T4	Inner wall channel
T5	Alu threshold
T6	Slide-in channel
T7	Hinge A
T8	Hinge B
T9	O handle
T10	St4 x 16
T11	St5 x 40 3 pieces
T12	St4 x 10 3 pieces
T13	Wall plug 3 pieces
T14	Bottom seal
T15	Door seal
T16	Door anti-collision seal
T17	Screw cap 3 pieces

Tieton Shower Door

1 DETERMINE THE DOOR CONFIGURATION

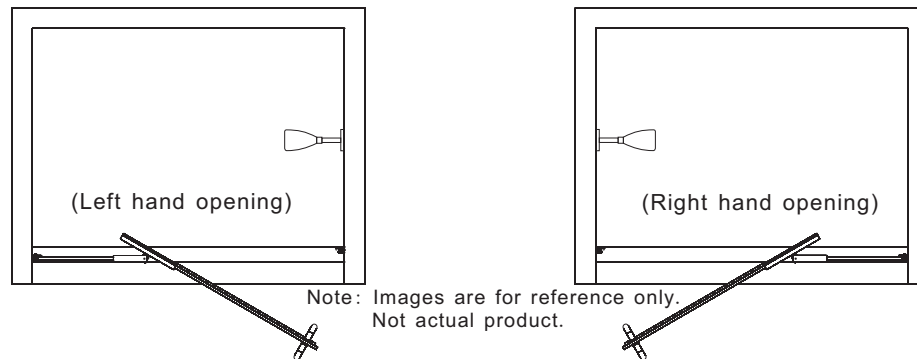

IMPORTANT! Install the pivot side of the door on the side opposite the shower head for easy access to shower controls.

Determine whether the door will pivot on the right or left side.

Make sure the door can swing freely in the chosen configuration.

2 MEASURE AND CUT THE ALU. THRESHOLD

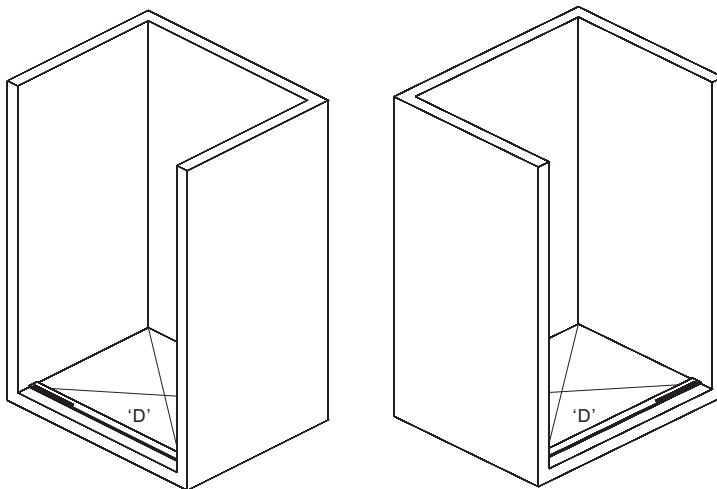

CAUTION: Risk of personal injury. Always wear safety glasses while cutting.

- Measure from wall to wall at the bottom of the shower door opening. This is distance "D".
- Mark the alu. threshold at the determined distance. Cut from end with NO slide-in channel.

Note: For best results use a miter box and 32-tooth per inch hacksaw to make the cut.

- Cut the rough edges smooth where the threshold was cut. Taking care to avoid damaging finished surfaces.
- The cut alu. threshold should sit flush on the base threshold without hand pressure or tape to hold it down.

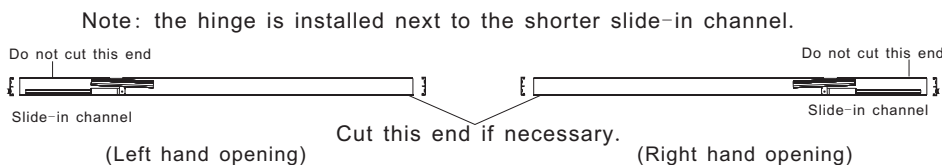

Tieton Shower Door

3 LOCATE THE ALU. THRESHOLD

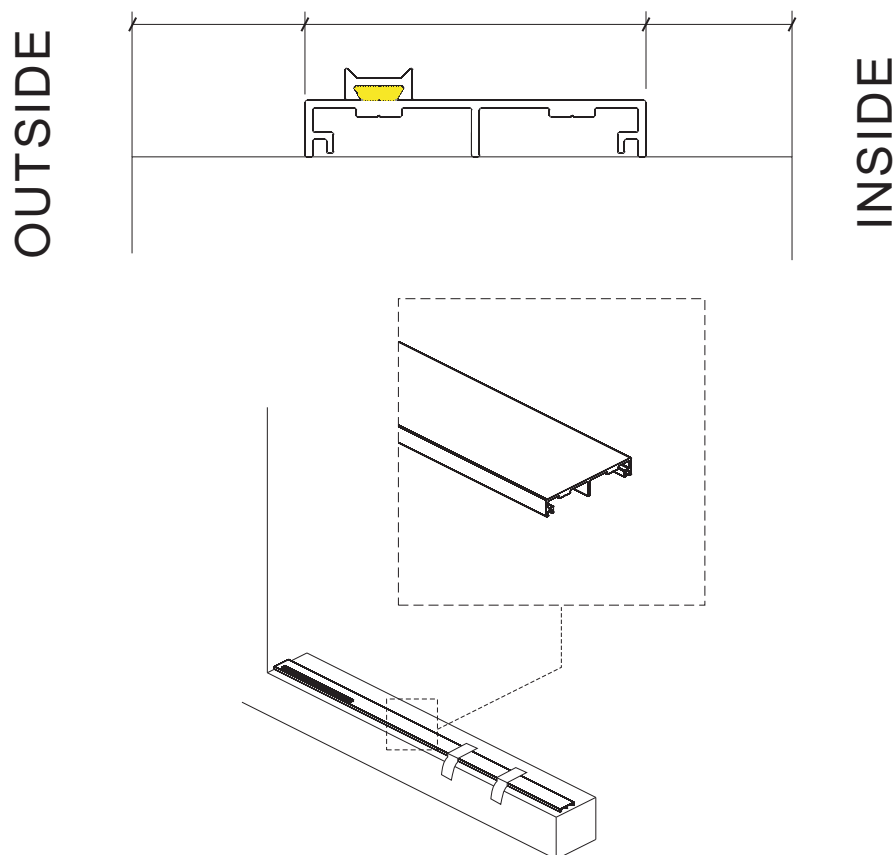

- Position the alu. threshold in the middle of the shower threshold.
- Temporarily secure the alu. threshold to the ledge with masking tape (do not apply the tape over the location of the filler strips).
- Mark the location of the bottom track with a soft pencil.

Tieton Shower Door

4 LOCATE THE INNER WALL CHANNEL

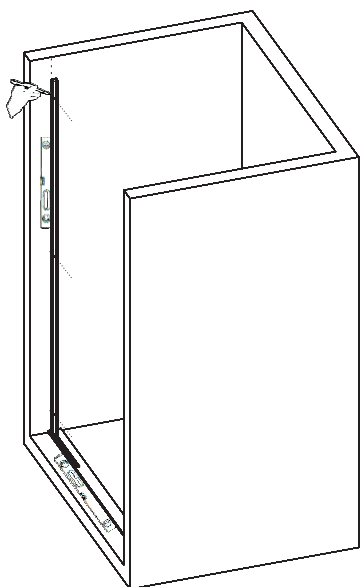

- Choose one piece of inner wall channel.
- Position the wall channel on the bottom track (threshold).
- Plumb wall channel and mark screw hole locations.

5 DRILL ANCHOR HOLES

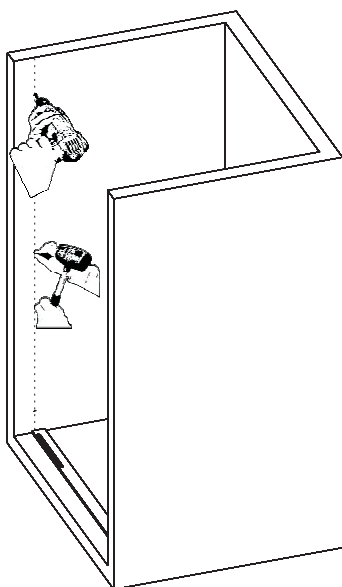

- Using 8mm bit drill anchor holes.
- Tap in screw anchors.

6 ATTACH INNER WALL CHANNEL

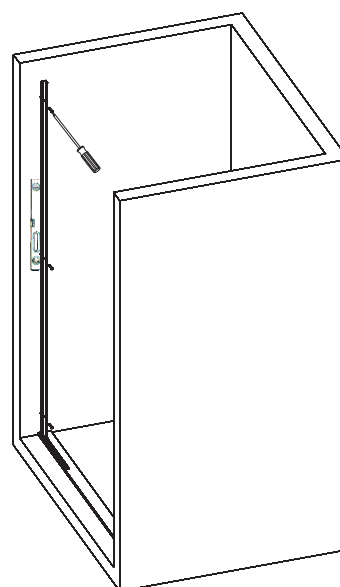

- Position wall channel over anchor holes and on top of bottom track.
- Re-plumb and attach with screws.

Tieton Shower Door

7 INSTALL THE SLIDE-IN CHANNEL

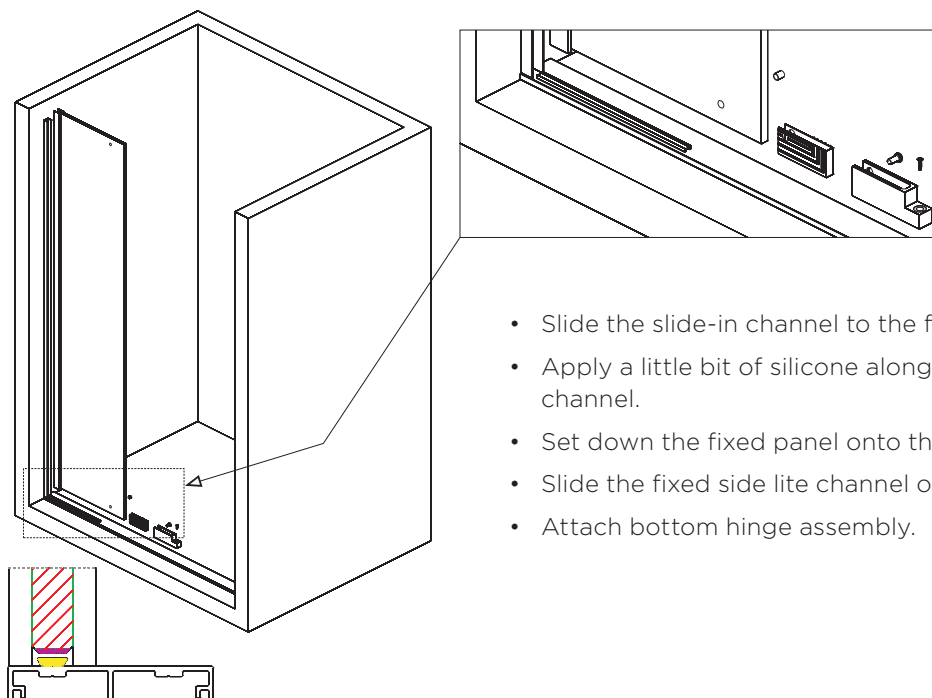

- Slide the slide-in channel to the fixed dovetail.
- Apply a little bit of silicone along the surface of slide-in channel.
- Set down the fixed panel onto the slide-in channel.
- Slide the fixed side lite channel over the wall channel.
- Attach bottom hinge assembly.

8 INSTALL THE WALL JAMB

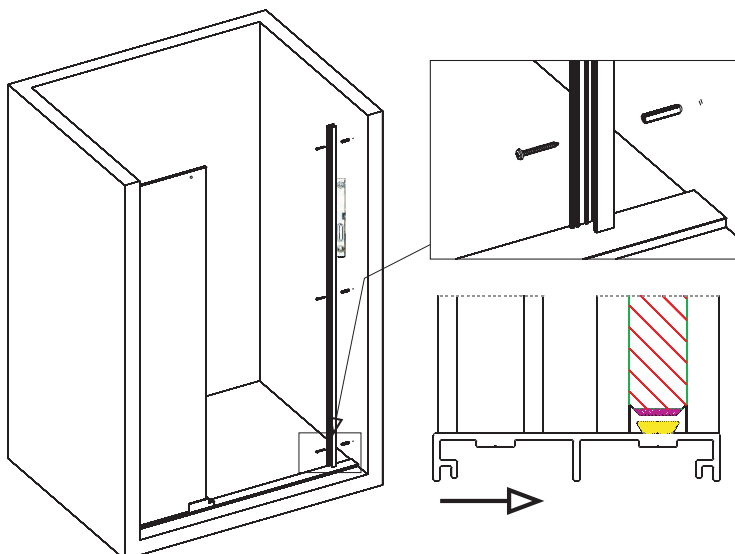

- Position the wall jamb on the bottom track (threshold).
- Plumb wall jamb and mark screw hole locations.
- Using 8mm bit drill anchor holes.
- Tap in screw anchors.
- Position wall jamb over anchor holes and on top of bottom track.
- Re-plumb and attach with screws.

Tieton Shower Door

9 SCREW THE WALL CHANNEL

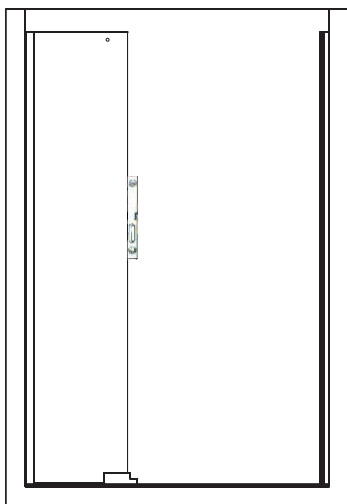

- Drill 3 pilot holes with 1.6mm (1/16") bit through fixed side lite channel and wall channel.
- Fasten channels with screws and cap.
- Attach bottom hinge to threshold with set screw.

10 INSTALL THE DOOR ANTI-COLLISION SEAL AND DOOR SEAL

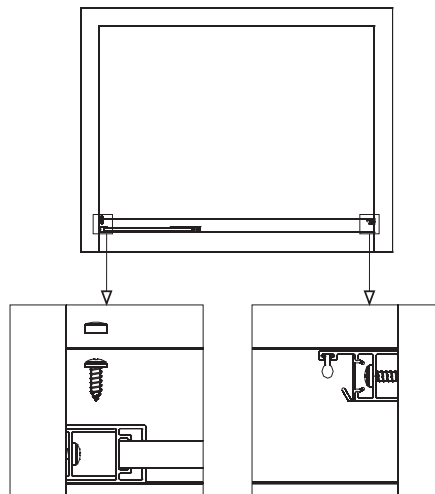

- Press the anti-collision seal into wall jamb.
- Slide the door seal from top to bottom.

11 INSTALL DOOR HANDLES

- Install door handles as shown.

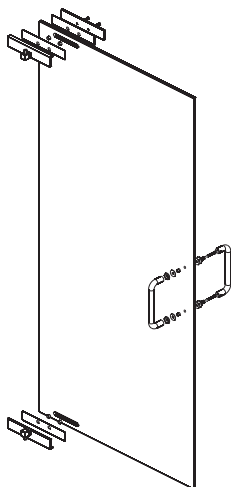

12 INSTALL DOOR HINGES

- Install top and bottom door hinge with spacers on each side into the slots in the glass door.
- Tighten set screws with hex wrench.

13 INSTALL GLASS DOOR

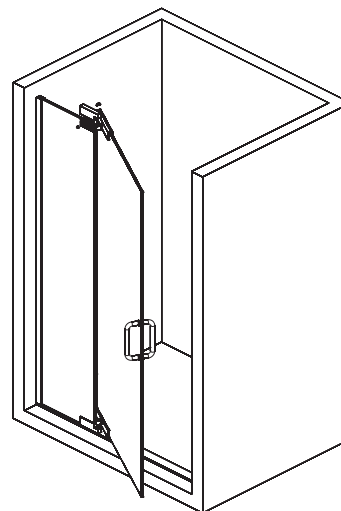

- Install door hinge into bottom hinge.
- Install top hinge.

Tieton Shower Door

14 ADJUST THE DOOR

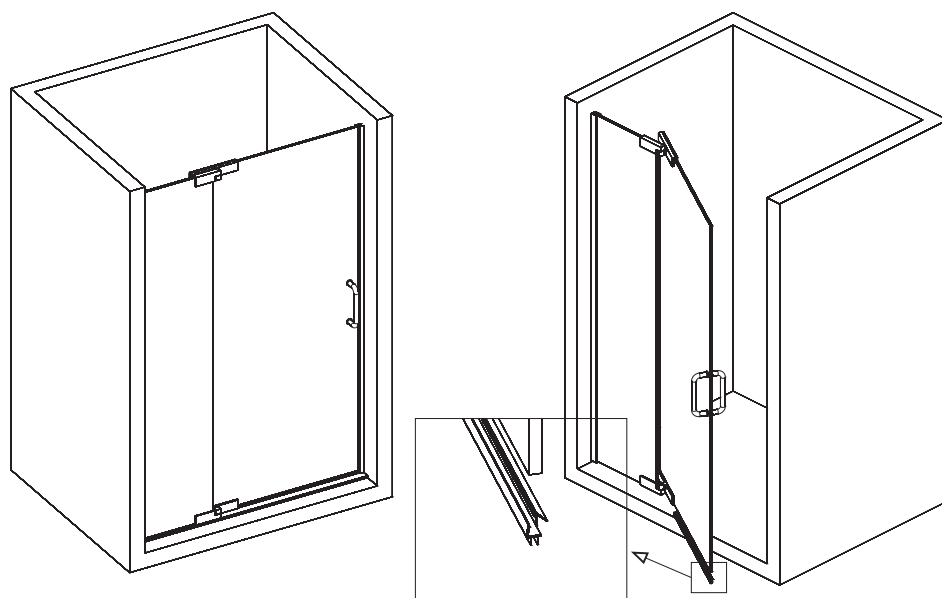

- Adjust the door by loosening the hex screws. Make adjustment and retighten the hex screws.
- Cut the bottom seal to fit between the leading edge of the door hinge and the door seal.

15 SEAL THE DOOR ASSEMBLY

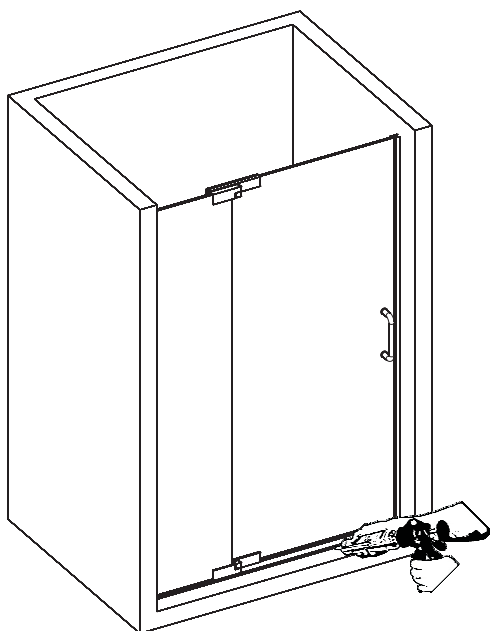

- Apply silicone outside and inside of the shower where the bottom track meets the threshold.
- Apply silicone outside and inside of area where wall channels meet the walls.
- Allow the silicone to fully dry before operating the door (24 hours is recommended).